

Fixture Number				
Project Title		Type		Qty
Comments				



## W217 | Albany II

- White Acrylic Diffuser
- Horizontal Top & Vertical Trim Bars
- Solid Top & Bottom
- ADA

### Dimensions and Lamping:

<b>W217-24</b>	7" A x 24" B x 4" D x 12" MC	Weight: 9 lbs.
<b>LN</b>	LED: Nominal 25W, 1450 Delivered Lumens	
<b>W217-36</b>	7" A x 36" B x 4" D x 18" MC	Weight: 12 lbs.
<b>LN</b>	LED: Nominal 40W, 2600 Delivered Lumens	
<b>W217-48</b>	7" A x 48" B x 4" D x 24" MC	Weight: 18 lbs.
<b>LN</b>	LED: Nominal 55W, 3750 Delivered Lumens	

### LED Color Temperature:

35K 3500K      **30K** 3000K      **40K** 4000K

### Control:

CLV Integral Power Supply, 0-10V Dimming to 1%

### Voltage:

1 120V      **2** 277V      **MV** Multi-Volt

### Diffusers:

**WA** Gloss White Acrylic  
**WM** Matte White Acrylic

### Standard Finishes:

<b>PAL</b> Aluminum	<b>PSB</b> Satin Black	<b>PRD</b> Traffic Red (RAL 3020)
<b>PNL</b> Nickel	<b>PBB</b> Brushed Brass	<b>POR</b> Pure Orange (RAL 2004)
<b>PBR</b> Bronze	<b>PAB</b> Antique Brass	<b>PYL</b> Traffic Yellow (RAL 1023)
<b>PLB</b> Light Bronze	<b>PHB</b> Hammered Bronze	<b>PGR</b> Emerald Green (RAL 6001)
<b>PMB</b> Medium Bronze	<b>PHC</b> Hammered Copper	<b>PBL</b> Signal Blue (RAL 5005)
<b>PDB</b> Dark Bronze	<b>PHS</b> Hammered Silver	<b>STBD</b> To Be Determined
<b>PRB</b> Oil Rubbed Bronze	<b>PSG</b> Satin Gold	
<b>PMW</b> Matte White	<b>PPA</b> Patina	

### Premium Finishes:

<b>BA</b> Brushed Aluminum	<b>PB</b> Polished Brass
<b>SN</b> Satin Nickel	<b>AB</b> Antique Brass
<b>PC</b> Polished Chrome	<b>PTBD</b> To Be Determined
<b>BB</b> Brushed Brass	

### Other Options:

**REM** Remote Emergency Power Supply



### DISTRIBUTION

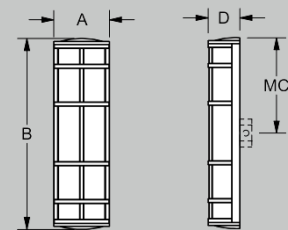
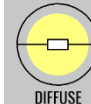

### Notes:

- Custom sizes and finishes available upon request.
- Camman reserves the right to make design changes without prior notice.
- Mounting is to a 4 inch octagonal junction box.
- Photometric information is available at [cammanlighting.com](http://cammanlighting.com)